

CLUB PRO JR.

PCP - PRE CHARGED PNEUMATIC

OWNER'S MANUAL

Specifications	Club Pro Junior
Power source	PCP
Mechanism	Side Lever Loading
Caliber	4.5 mm (0.177")
Velocity	175mps / 575fps
Power	7.5 joules / upto 5.5 ft-lb
Max. Pressure	160 bar
Weight	2.8 kg
Total Length	992mm
Barrel Length	500 mm
Shots Per Fill	150 consistent shots

Before using this Air Rifle thoroughly read all instructions and warnings in the Manual.



Disassembly of your air rifle will void your warranty!

Tampering with the components, or unauthorized modifications and alterations may make the air rifle unsafe to use and also will invalidate the warranty and may attract legal consequences.

We strongly advise against disassembly or modifying your air rifle. The PCP air rifles are charged at very high pressure. Disassembly of air rifle while it is charged may lead to serious injuries or even death. If there is any physical damage to air cylinders the air rifle must be taken for inspection to an authorized service center.

Please ensure that all the fields below are filled and it carries the inspection date and sign.

Customer Name	
Club Pro Junior	<input type="checkbox"/>
Serial Number	
Inspection Sign :	
Date :	

NOTICE

- PX100 Club Pro Junior air rifle comes with a Pellet Tray, a Aperture Front sight and a Rear Aperture sight. Pressure range is between : **160 bar - 70 bar**.
- DO NOT discharge the rifle completely i.e. do not go below the minimum specified pressure for your air rifle. This could result in leakage.
- OVERFILLING the air rifle beyond the maximum specified pressure would lead to valve lock and damage the seals. This would also result in low velocity.
- Club Pro Junior Air rifle can be dangerous upto 300m.

WARNING

- Precision air rifles, because of their design are a special class of guns having very sensitive trigger mechanisms, light trigger pulls and may fire if dropped or jarred abruptly. Careless use of an air rifle can cause serious injuries.
- PCP air rifles are designed specifically for use with dry compressed air. No other gas combination can be used.
- Ensure that you are aware of all the local laws regarding ownership of air rifle. You should always obey all the local laws.
- Anyone under 18 years of age must always be under the 'immediate supervision' of an adult experienced in operating air rifles.

SAFETY INFO

- Always keep the muzzle pointed in a safe direction. Never point it at something you don't want to shoot. Keep the muzzle pointed either upwards or downwards towards the ground.
- Make sure you note the danger distance of the air rifle i.e. how far the pellets can travel. Also ensure that your target has a safe backstop i.e. Think of what you might hit if the pellet misses or goes through the intended target.
- Always keep your finger away from the trigger and out of the trigger guard until ready to shoot.
- An air rifle has a potential of serious injury. Treat every rifle as if it were loaded. Keep it unloaded until ready to shoot. Move the safety lever to off position only when ready to shoot.
- An air rifle "Safety" is a mechanical device. Like all mechanical devices, it can fail. Never rely on a rifle's "Safety" to protect you and others from unsafe handling. A safety is not a substitute for common sense and good safety procedures.
- When removing any air rifle from storage, or when receiving it from another person, check immediately to see if it is loaded.
- Do not be under the influence of alcohol or drugs while shooting. Handling and using an air rifle requires your full and continuous attention, alertness, and unimpaired judgment.

LEARN THE PARTS

Before learning how to operate, let's first identify various parts of your PX100 series air rifle.

Club Pro Junior

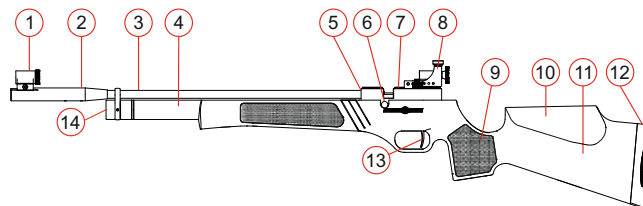

- 1) Front Sight
- 2) Muzzle Weight
- 3) Barrel
- 4) Reservoir Tube
- 5) Receiver Block
- 6) Safety Button
- 7) Mounting Rail
- 8) Aperture Rear Sight - 20 Clicks
- 9) Grip
- 10) Cheek Piece
- 11) Stock
- 12) Butt Pad
- 13) Trigger
- 14) Pressure Gauge

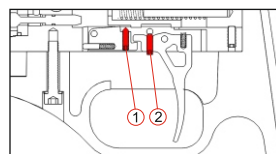

1. Trigger Point / Sear Engagement (Tool required : 1.5 mm Allen Key)
Turning Clockwise decreases resistance of the second stage and Counter-Clockwise increases resistance of the second stage.
WARNING: Turning Clockwise too much will prevent gun from cocking.
2. First Stage, Length of pull (Tool required: 1.5 mm Allen Key)
Turning Clockwise will reduce the amount of first stage travel and Counter-Clockwise will increase the amount of first stage travel.
WARNING: Turning Clockwise too much will eliminate the 2nd stage and prevent sear engagement.

AIR RIFLE MAINTENANCE

- Apply a thin layer of suitable grease occasionally or when dried out to the fill probe o-rings.
- To prevent rust from forming due to sweat from your hands, exterior surfaces should be wiped down with an oiled cloth after every use to maintain the quality of finish. (Never Use Strong Chemicals or Water).
- Before you begin oiling or cleaning your rifle, always check to make sure it is unloaded. (Do Not over-lubricate the Rifle)
- It is recommended to clean the barrel with a pull through every 500-1000 shots. Do not use harsh firearm bore cleaners.
- After a period of time, the O-rings on the fill probe will need to be replaced. The need for this will become noticeable if air is heard leaking from the fillprobe or the fillprobe is ejected from the port while charging the rifle. Always ensure to replace both O-rings on the fill probe.
- Store in a place that is dry and dark. Store the rifle with a pressure between 160-70 bar for Club Pro Junior

WARRANTY INFO



OPERATING INSTRUCTIONS

1. FILLING THE PCP AIR RIFLE

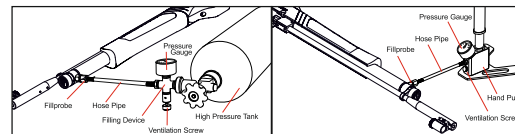

A quick fill connector comes with the rifle and is threaded with a 1/8" BSP male thread to fit the female thread of the hose pipe of the filling device or Hand pump.

Make sure that the fill probe and filler hole are clear from any dirt. Feel free to use lubricant on the o-rings to increase their life. **NOTE: use any lubricant in moderation.**

Fill probe: Rotate the dust cover to expose the fill probe hole. Insert the fill probe completely into the rifle filler hole located at the end of the air tube.

- FILLING DEVICE:** Close ventilation screw on the charging source. Charge the rifle to a Maximum level specified. (Do not over fill pressure). Always check the pressure on the charging source (filling device). Close the tap on the air bottle. Unscrew the ventilation screw on the filling device to vent the residual air in the hose pipe before removing the fill probe from the rifle.
- HAND PUMP:** When using a hand pump use the ventilation screw on the pump always. Due to continual usage the pump body will become very warm. Allow it to cool down for several minutes before continuing. As pressure increases, more force is required to pump. It is normal if you start to find it hard to pump once the pressure increases. Check the pressure on the Hand Pump gauge as they are more reliable. Do not pump beyond the maximum pressure level specified.

2. COCKING, LOADING AND LOCKING

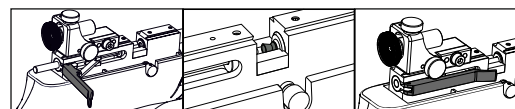

- Pull the cocking lever / handle backward as far as possible till click of sear engaging is felt.
- Insert a pellet of appropriate caliber into the barrel breech or simply lay the pellet in the pellet tray as shown in the picture. Be careful not to squeeze or damage the pellet as this could affect accuracy.
- Close the cocking lever / handle forward till it locks in place. This chambers the pellet into the barrel. The rifle is now cocked and ready to fire.

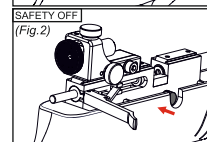
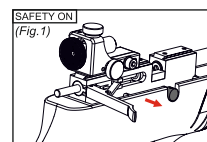

3. AIR RIFLE SAFETY LOCK

Safety button can be set to 'ON' and 'OFF' position manually. To set the safety to 'ON', push the safety lever to the right. The rifle has to be in cocked position while moving safety from 'ON' to 'OFF' or vice versa. In this position, the hammer is blocked and the air rifle cannot fire. (Fig. 1) You can use this position to do dry fire training.

To move the safety to 'OFF', push safety lever to the left after cocking the rifle. In this position, the rifle is ready to shoot (Fig. 2)

CAUTION: Until you are actually ready to shoot, keep the safety in the 'ON' position (Fig. 1)

Before firing the rifle ensure safety is in fire position.

4. SIGHT ADJUSTMENT

Precision Aperture Rear Sight: (20 Clicks)

Elevation and windage on the Precihole Sports rear sight are controlled by micro click adjustable knobs. The shift in point of impact at 10m distance:

0.35 mm per click / 8 clicks per ring in the Club Pro Junior.

- If the shot impacts low, Turn the elevation knob clockwise to raise the point of impact. If it impacts high, Turn the elevation knob counter-clockwise to lower the point of impact.
- If the shot impacts left, Turn the windage knob counter-clockwise to move the point of impact to the right. If it impacts right, Turn the windage knob clockwise to move the point of impact to the left.

5. FIRING YOUR AIR RIFLE

Ensure the cocking handle is fully closed before firing the rifle as its performance will be affected if not fully closed. Close the cocking handle till it locks in place. Aim at your intended target and disengage the safety and prepare to shoot. Pull the trigger gently and the rifle will fire. To reload rifle, pull the cocking handle to its rear-most position and follow the point 2. (Cocking, Loading & Locking).

NOTE: Many factors affect the velocity, including the ammunition brand and weight, lubrication, barrel condition and temperature.



Scan & Follow us
@ f x

Manufacturer
PRECIHOLE SPORTS PVT. LTD.
www.preciholesports.com
info@preciholesports.com

Official Global Distributor
AIR ARMS
www.air-arms.co.uk
sales@air-arms.co.uk
01323 844760