

MATCH PRO PISTOL

PCP - PRE CHARGED PNEUMATIC



OWNER'S MANUAL

Specifications	Match Pro Pistol	Specifications	Match Pro Pistol
Power source	PCP	Barrel	12 Groove Right Hand Twist 1 in 450mm
Mechanism	Lever Loading	Front Sight	4.5mm width - Replaceable Element
Caliber	4.5 mm (0.177")	Rear Sight	4.2 - 4.6mm Notch - Replaceable Element
Velocity	150 mps / 490 fps	Safety / Dry Fire	Manual (Hammer Blocking)
Power	5.5 joules / Upto 4.1ft-lb	Trigger	Two - Stage Adjustable Match-Grade Trigger.
Max. Pressure	160 bar / 2320 PSI	Butt / Stock	Ambidextrous Anatomical Grip with Adjustable Palm - Shelf.
Weight	1 kg		
Total Length	422mm		
Barrel Length	245 mm		
Shots Per Fill	140 Consistent Shots		

Before using this Air Pistol thoroughly read all instructions and warning in the Manual.



Disassembly of your air pistol will void your warranty!

Tampering with the components, or unauthorized modifications and alterations may make the air pistol unsafe to use and also will invalidate the warranty and may attract legal consequences.

We strongly advise against disassembly or modifying your air pistol. The PCP air pistol are charged at very high pressure. Disassembly of air pistol while it is charged may lead to serious injuries or even death. If there is any physical damage to reservoir tube the air pistol must be taken for inspection to an authorized service center.

Please ensure that all the fields below are filled and it carries the inspection date and sign.

Customer Name		Inspection Sign :	
Match Pro Pistol	<input type="checkbox"/>	Date :	
Serial Number			

NOTICE

- Operating Pressure range: **160 bar ~ 70bar.**
- DO NOT discharge the pistol completely i.e. do not go below the minimum specified pressure for your air pistol. This could result in leakage.
- OVERFILLING the air pistol beyond the maximum specified pressure would lead to valve lock and damage the seals. This would also result in low velocity.
- Match Pro air pistol can be dangerous up to 300m.

WARNING

- Precision air pistol, because of their design are a special class of guns having very sensitive trigger mechanisms, light trigger pulls and may fire if dropped or jarred abruptly. Careless use of an air pistol can cause serious injuries.
- PCP air pistol are designed specifically for use with dry compressed air. No other gas combination can be used.
- Ensure that you are aware of all the local laws regarding ownership of air pistol. You should always obey all the local laws.
- Anyone under 18 years of age must always be under the 'immediate supervision' of an adult experienced in operating air pistol.

SAFETY INFO

- Always keep the muzzle pointed in a safe direction. Never point it at something you don't want to shoot. Keep the muzzle pointed either upwards or downwards towards the ground.
- Make sure you note the danger distance of the air pistol i.e. how far the pellets can travel. Also ensure that your target has a safe backstop i.e. Think of what you might hit if the pellet misses or goes through the intended target.
- Always keep your finger away from the trigger and out of the trigger guard until ready to shoot.
- An air pistol has a potential of serious injury. Treat every pistol as if it were loaded. Keep it unloaded until ready to shoot. Move the safety lever to off position only when ready to shoot.
- An air pistol "Safety" is a mechanical device. Like all mechanical devices, it can fail. Never rely on a pistol's "Safety" to protect you and others from unsafe handling. A safety is not a substitute for common sense and good safety procedures.
- When removing any air pistol from storage, or when receiving it from another person, check immediately to see if it is loaded.
- Do not be under the influence of alcohol or drugs while shooting. Handling and using an air rifle requires your full and continuous attention, alertness, and unimpaired judgment.

INSIDE THE BOX

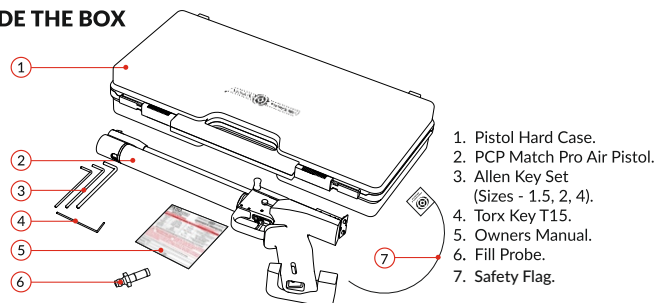

LEARN THE PARTS

Before learning how to operate, lets first identify various parts of your Match Pro series air pistol.

- Front Sight
- Barrel
- Cocking Lever
- Safety / Dry fire Button
- Rear Sight
- Pressure Gauge
- Reservoir Tube
- Trigger

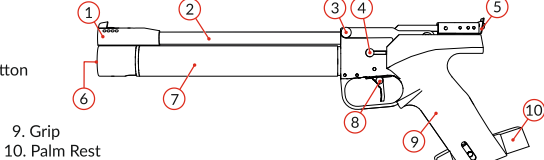

TRIGGER SETTING

- Length of first pull
- Weight of first pull
- Trigger stop
- Weight of second pull
- Trigger point

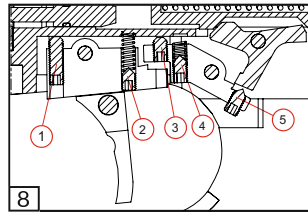

TRIGGER SHOE & PALM REST ADJUSTMENT

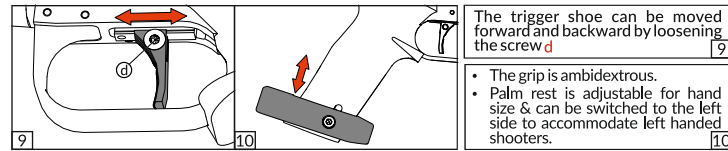

AIR PISTOL MAINTENANCE

- Apply a thin layer of suitable grease occasionally or when dried out to the fill probe o-rings.
- To prevent rust from forming due to sweat from your hands, exterior surfaces of the barrel should be wiped down with an oiled cloth after every use to maintain the quality of finish.
- Before you begin oiling or cleaning your pistol, always check to make sure it is unloaded.
- After a period of time, the O-rings on the fill probe will need to be replaced. The need for this will become noticeable if air is heard leaking from the fill probe or the fill probe is ejected from the port while charging the pistol. Always ensure to replace both O-rings on the fill probe.
- Store in a place that is dry and dark. Store the pistol with a pressure between 160-70 bar for Match Pro.

WARRANTY INFO



OPERATING INSTRUCTIONS

1. FILLING THE PCP AIR PISTOL

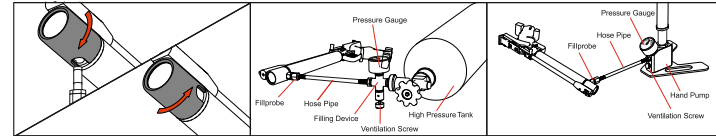

A quick fill connector comes with the pistol and has a 8mm foster male fitting to connect to the 8mm foster female fitting of the hose pipe of the filling device or Hand pump.

Make sure that the fill probe and filler hole are clear from any dirt. Feel free to use lubricant on the o-rings to increase their life. **NOTE: use any lubricant in moderation.**

Fillprobe: Rotate the dust cover to expose the fill probe hole. Insert the fill probe completely into the pistol filler hole located at the end of the air tube.

1 FILLING DEVICE: Close ventilation screw on the charging source. Charge the pistol to a Maximum level specified. (Do not over fill pressure). Always check the pressure on the charging source (filling device). Close the tap on the air bottle. Unscrew the ventilation screw on the filling device to vent the residual air in the hose pipe before removing the fill probe from the pistol.

2 HAND PUMP: When using a hand pump use the ventilation screw on the pump always. Due to continual usage the pump body will become very warm. Allow it to cool down for several minutes before continuing. As pressure increases, more force is required to pump. It is normal if you start to find it hard to pump once the pressure increases. Check the pressure on the Hand Pump gauge as they are more reliable. Do not pump beyond the maximum pressure level specified.

2. COCKING, LOADING AND LOCKING

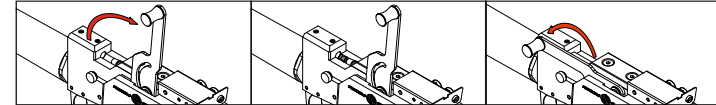

- Pull the cocking lever / handle backward as far as possible till click of sear engaging is heard.
- Insert a pellet of appropriate caliber into the barrel breech as shown in the picture. Be careful not to squeeze or damage the pellet as this could affect accuracy.
- Close the cocking lever / handle forward till it locks in place. This chambers the pellet into the barrel. The pistol is now cocked and ready to fire.

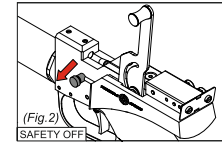
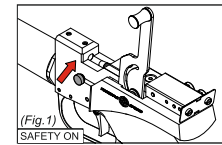

3. AIR PISTOL SAFETY LOCK / DRY FIRE

Safety button can be set to 'ON' and 'OFF' position manually. To set the safety to 'ON', push the safety lever to the right. The pistol has to be in cocked position while moving safety from 'ON' to 'OFF' or vice versa. In this position, the hammer is blocked and the air pistol cannot fire. (Fig.1) You can use this position to do dry fire training.

To move the safety to 'OFF', push safety lever to the left after cocking the pistol. In this position, the pistol is ready to shoot (Fig.2)

CAUTION: Until you are actually ready to shoot, keep the safety in the 'ON' position (Fig.1)

Before firing the pistol ensure safety is in fire position.

4. SIGHT ADJUSTMENT

Precision Rear Sight:

Elevation and windage on the Precihole Sports rear sight are controlled by micro click adjustable knobs. The shift in point of impact at 10m distance:

1.35mm per click / 6 clicks per ring in the Match Pro Pistol.

- If the shot impacts low, Turn the elevation knob clockwise to raise the point of impact. If it impacts high, Turn the elevation knob counter - clockwise, to lower the point of impact.
- If the shot impacts left, Turn the windage knob clockwise to move the point of impact to the right. If it impacts right, Turn the windage knob counter-clockwise to move the point of impact to the left.

5. FIRING YOUR AIR PISTOL

Ensure the cocking handle is fully closed before firing the pistol as its performance will be affected if not fully closed. Close the cocking handle till it locks in place. Aim at your intended target and disengage the safety and prepare to shoot. Pull the trigger gently and the pistol will fire. To reload pistol, pull the cocking handle to its rear-most position and follow the section 2. (Cocking, Loading & Locking).

NOTE: Many factors affect the velocity, including the ammunition brand and weight, lubrication, barrel condition and temperature.



Scan & Follow us
@ f x

Manufacturer
PRECİHOLE SPORTS PVT. LTD.
www.preciholesports.com
info@preciholesports.com

Official Global Distributor
AIR ARMS
www.air-arms.co.uk
sales@air-arms.co.uk
01323 844760